



AMTRAK Public Hearing on Train Accessibility

August 30th, 2023

Safety and Security Briefing



Emergency Preparedness

Our physical address is

Who will call 911, and who is their backup?

Who is CPR/AED qualified?

Know the location of emergency equipment.



Evacuation

Communicate the need to evacuate.

Follow the Facility Emergency Plan (FEP).

Know your evacuation plan/ route & muster point.

Assist those who may need help evacuating.

Wait for permission to re-enter the facility.



Safety Reporting

Proactively identify & report unsafe conditions or behaviors.

Use AVSRS through the Safety page on All Aboard or download the Enablon Go mobile app.

Report all safety concerns.

Questions contact Systemsafety@amtrak.com



Health and Wellbeing

Take healthy actions:

Physical Activity

Healthy Nutrition

Adequate Sleep

Mental Well-being

Stay up to date with preventive services.

Take time to refresh & recharge.



Security

If You See Something, Say Something®. Call 800-331-0008 / text 27311.

Active Shooter: Run, Hide, Fight.

Always be aware of surroundings.

Display and verify proper ID on Amtrak property.



Cybersecurity

Pay attention to phishing traps in emails.

Don't click on links or attachments from unknown sources.

Report all suspicious email and cyber incidents to the Amtrak Service Desk:

800-772-4357 or AmtrakServiceDesk@amtrak.com

Legend

The below color coding and marking system is used on the following preliminary design concept layouts to clearly identify the accessible features of the train design

AS		Accessible Space	Space for a person who wishes to remain in their wheelchair or mobility device
AB		Accessible Bedroom	Accessible bedroom with an en-suite accessible restroom with turning space
AR		Accessible Restroom	Accessible restroom with turning space and space to side transfer onto the toilet
E		Elevator	Elevator for passengers who use wheelchairs or who cannot use the stairs
32		32" Accessible Path	32" aisle width for passengers who use wheelchairs to access other areas of the train
60		60" Turning Space	A 60" diameter circular space for passengers who use a wheelchair to turn around
TS		Transfer Seat	A seat for those wishing to transfer from a wheelchair to a seat
WS		Wheeled Mobility Device Storage Space	A space reserved for those wishing to store a folded wheelchair or other foldable mobility aids
AS		Non-Accessible Seating, Rooms, or Crew Areas	Non-accessible aisles, seating areas, diner and lounge seating, private rooms, and/or crew rooms

Example Car Diagrams

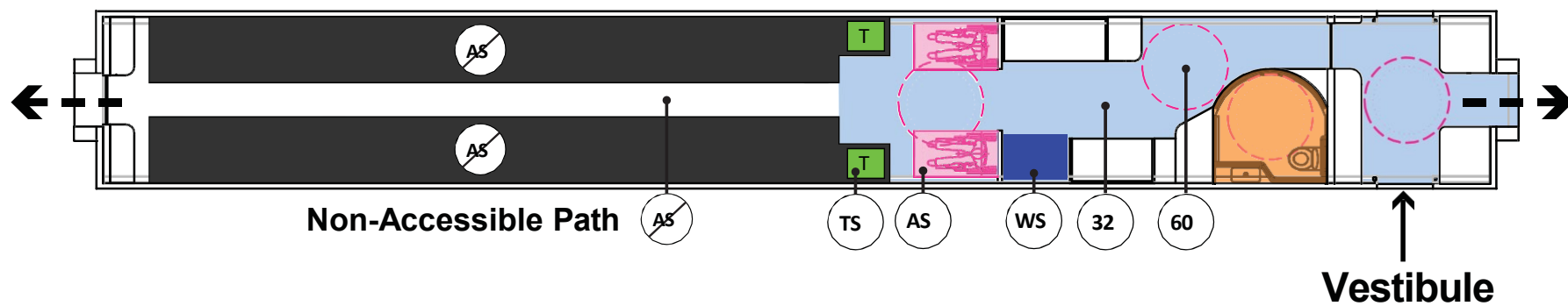

Single-Level Train Car

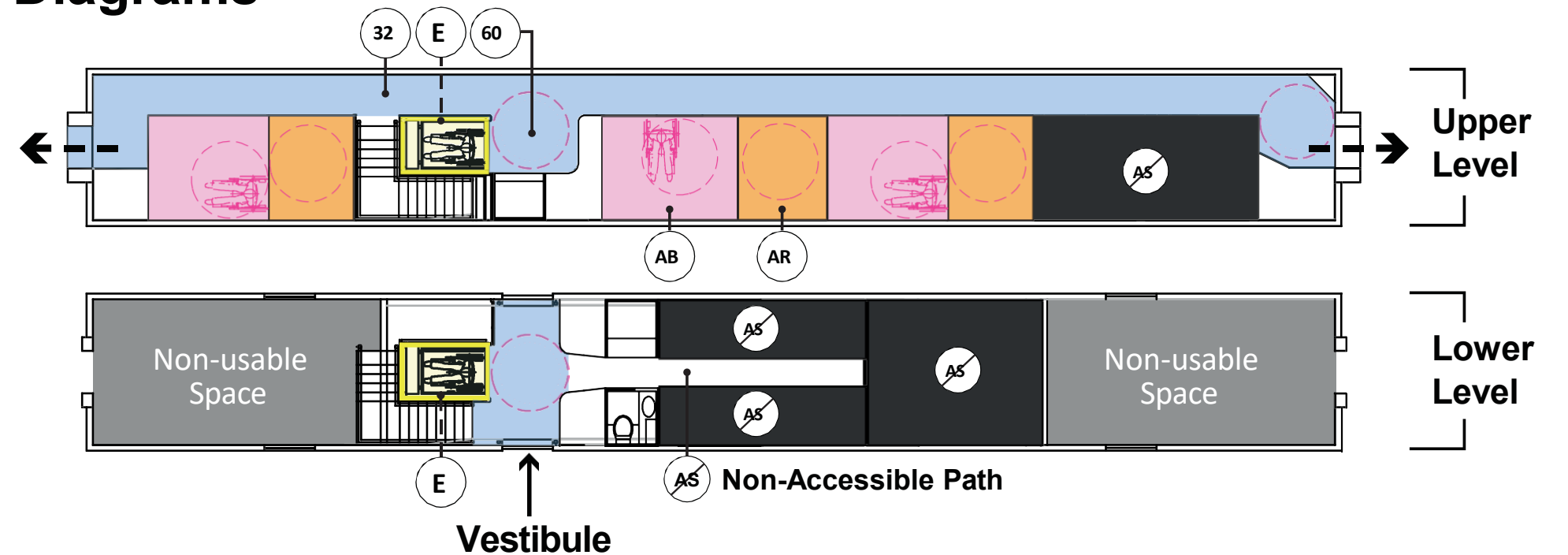

Bi-level Train Car

ADA | Concept Design

01 | Coach Car

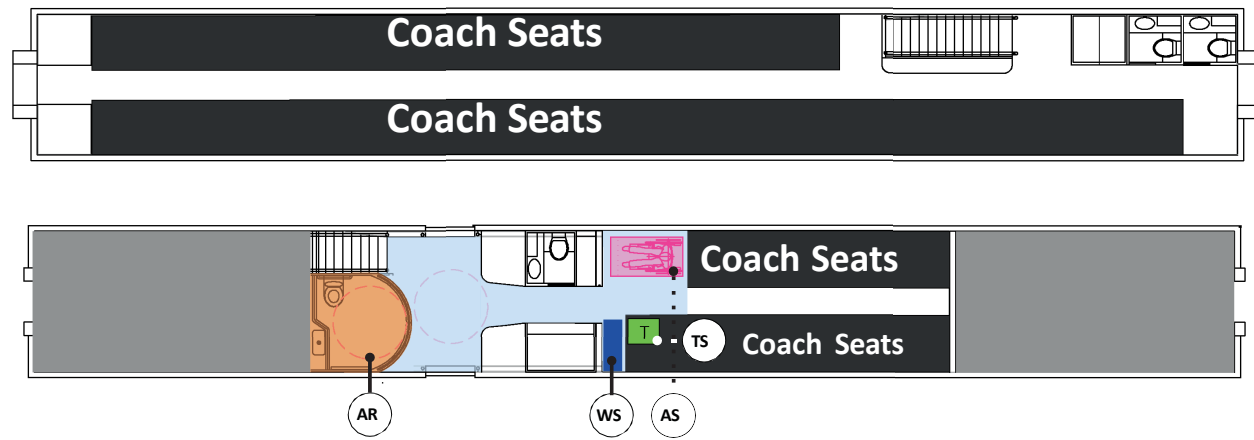

02 | Coach Car

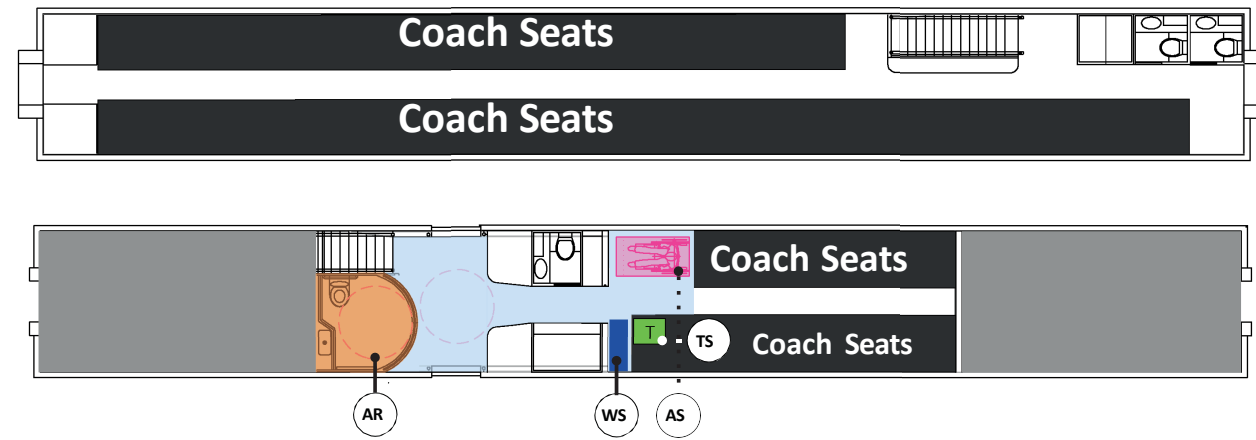

03 | Coach Cafe Car

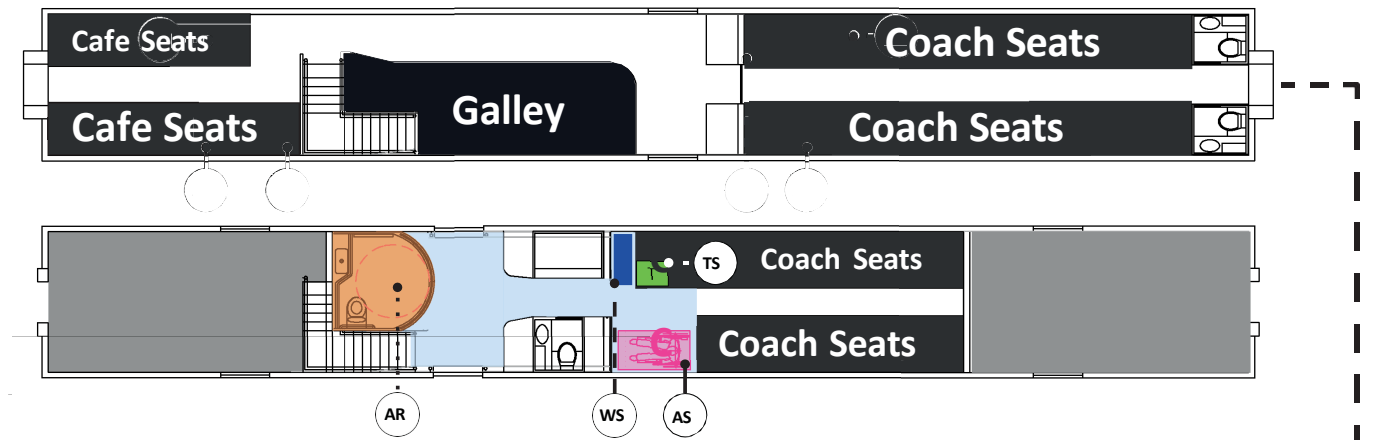

04 | Diner

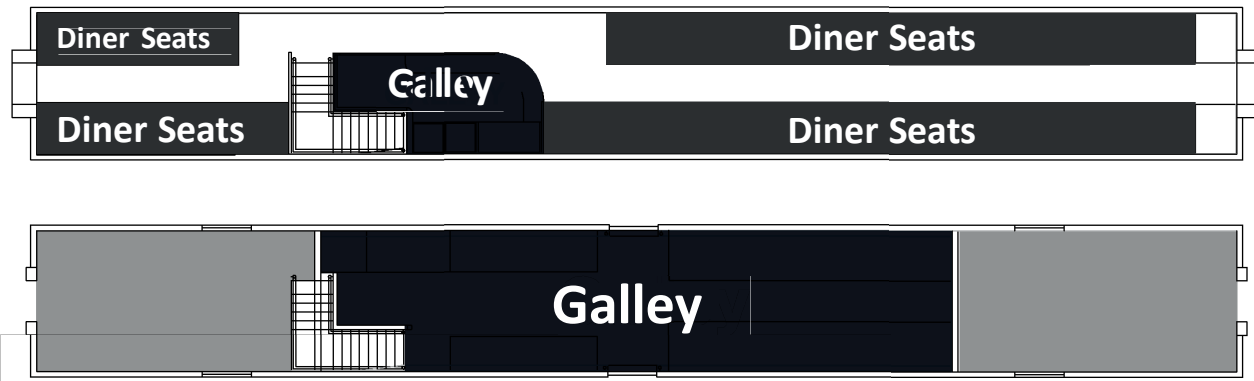

05 | Lounge Car

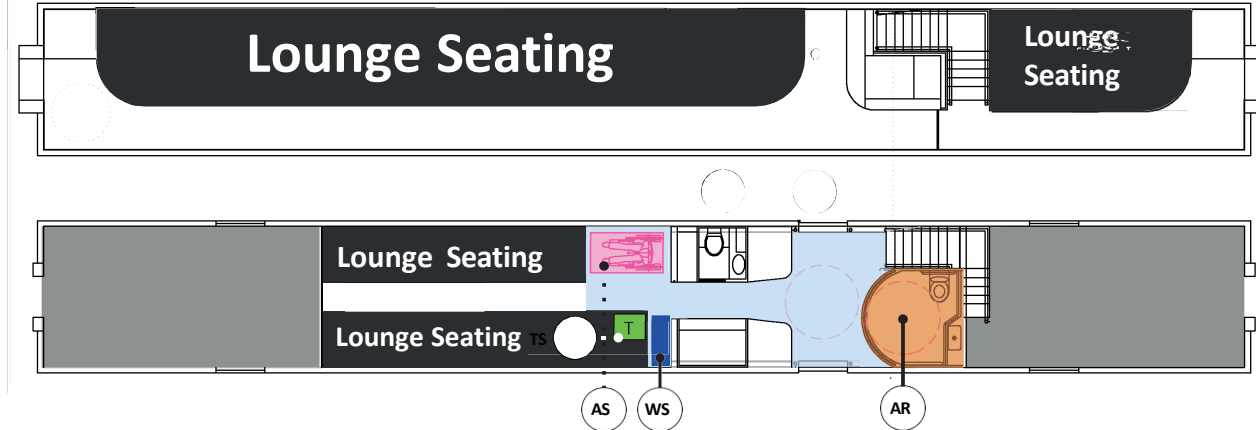

06 | Sleeper

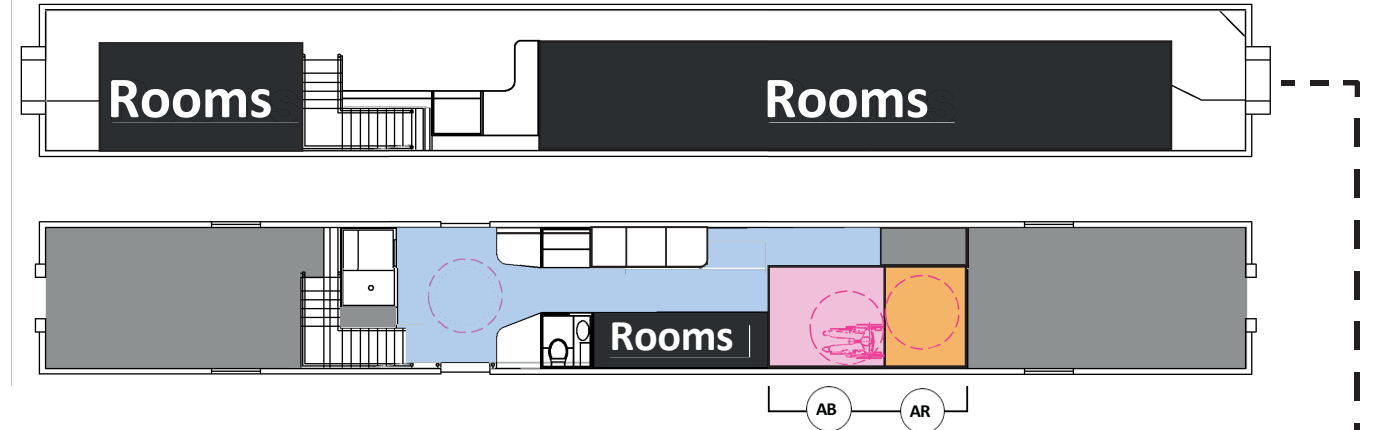

07 | Sleeper

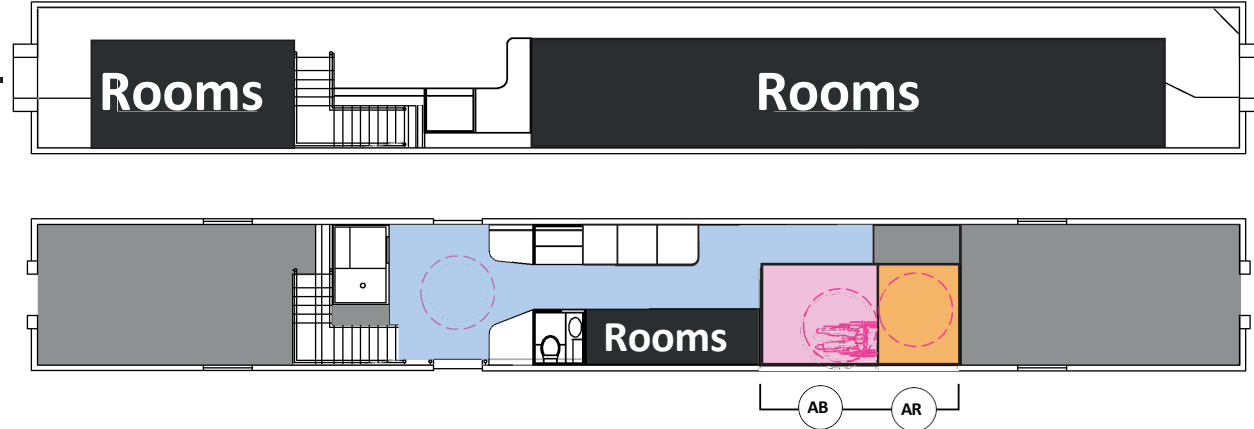

08 | Sleeper

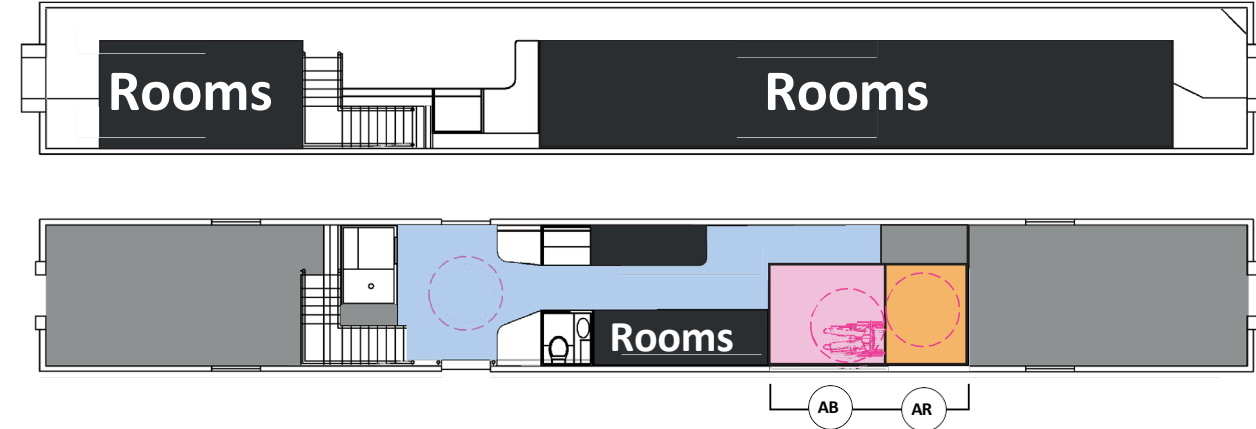

09 | Utility Car

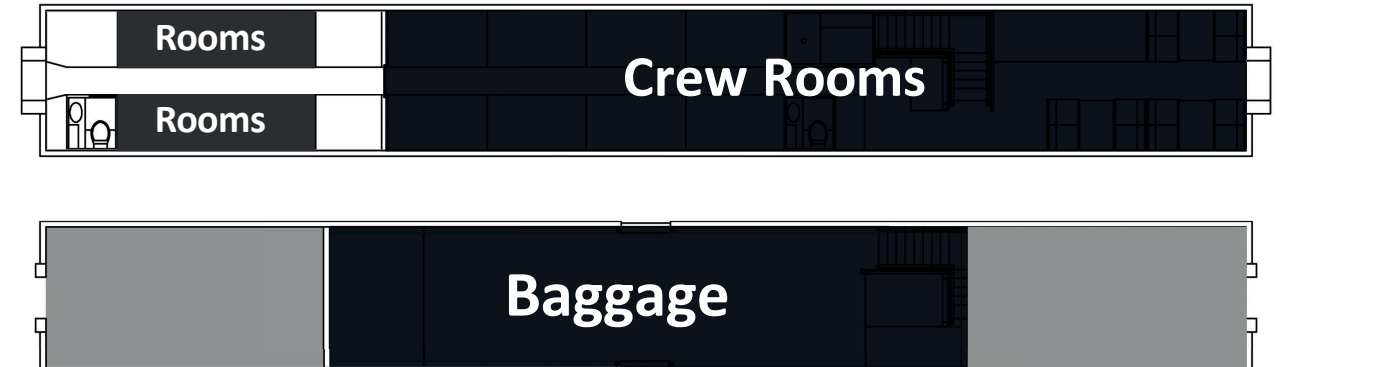

- AS Accessible Space
- AR Accessible Restroom
- 60 60" Turning Space
- WS Wheeled Mobility Device Storage Space
- AB Accessible Bedroom
- 32 32" Accessible Path
- TS Transfer Seat
- AS Non-Accessible Seating, Rooms, or Crew Areas

Alternative Design Standards

1. Accessible Core Trainset

- Enhanced mobility between cars, semi permanent coupling.

2. Number of Accommodations

- Number of accessible coach/bedroom spaces in a trainset equal to or greater than the number of coach/sleeper cars in the trainset.

3. Access to Amenities

- All accessible spaces within an accessible core area of the trainset, with access to amenities, via accessible 32” wide path.

4. Priority Positions

- Accessible sleeper and coach cars will have priority over any non-accessible sleeper and coach cars in terms of proximity to dining and lounge cars.

5. Access to Redundant Restrooms

- All accessible spaces will have access to at least two accessible restrooms, via an accessible 32” wide path.

6. Access to Redundant Vertical Access Points

- All accessible coach spaces and accessible bedrooms on the upper level of a bi-level train will have access, via an accessible 32” wide path, to at least two accessible elevators for boarding and deboarding.

Single-Level Trainset Arrangement | Preliminary EF Concept Design

01 | Coach Car

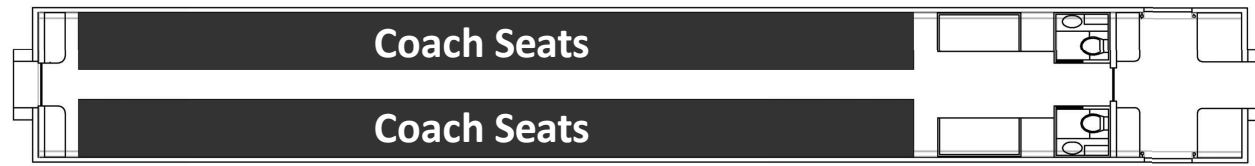

02 | Accessible Coach Car

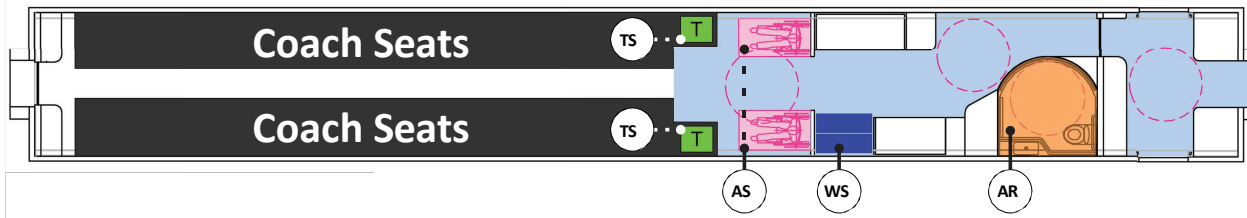

03 | Accessible Coach Car

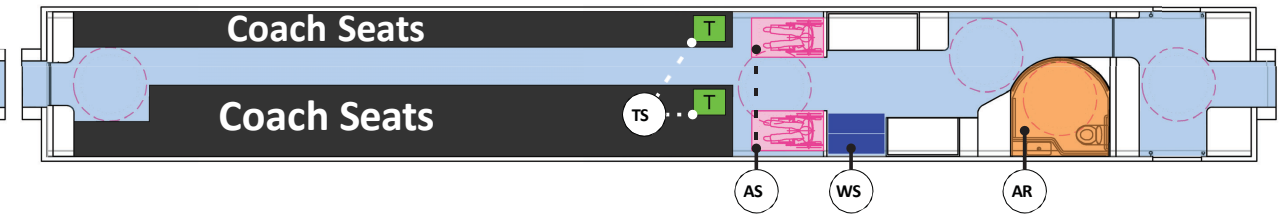

04 | Accessible Coach Cafe

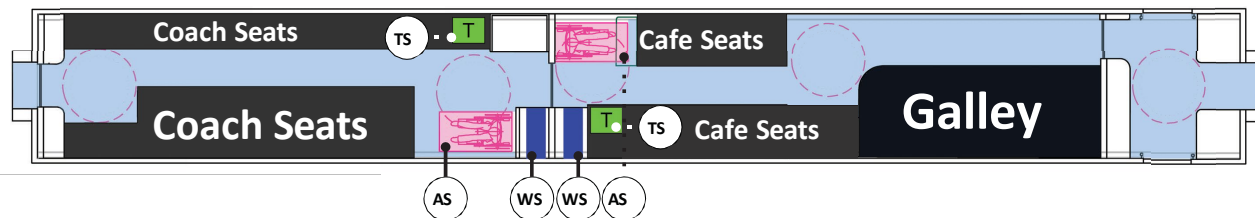

05 | Accessible Diner



06 | Accessible Diner/Lounge

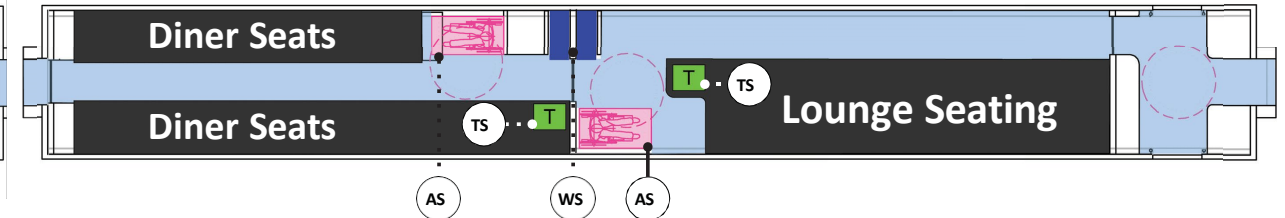

07 | Accessible Sleeper

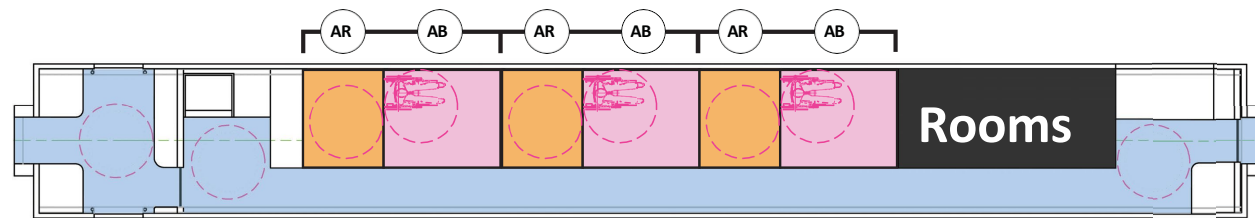

08 | Bedroom Sleeper

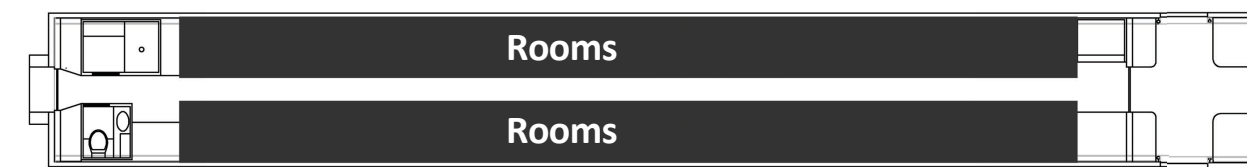

09 | Bedroom Sleeper

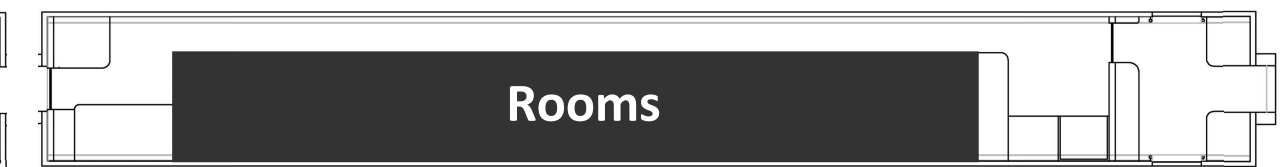

10 | Utility Car

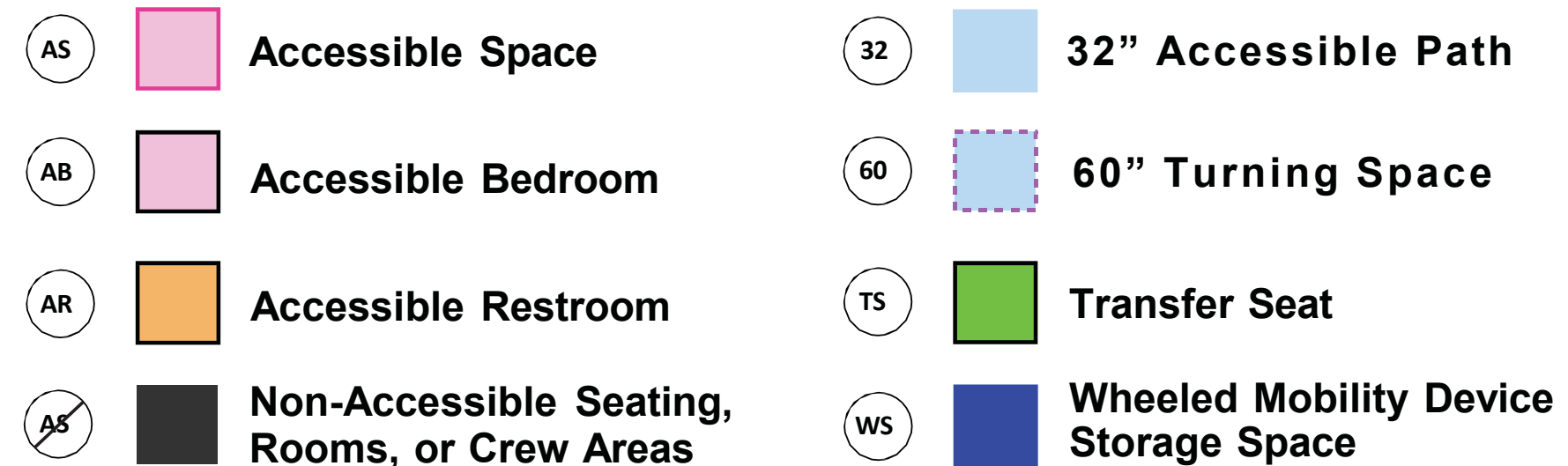

Bi-Level Trainset Arrangement | Preliminary EF Concept Design

01 | Accessible Coach End Car

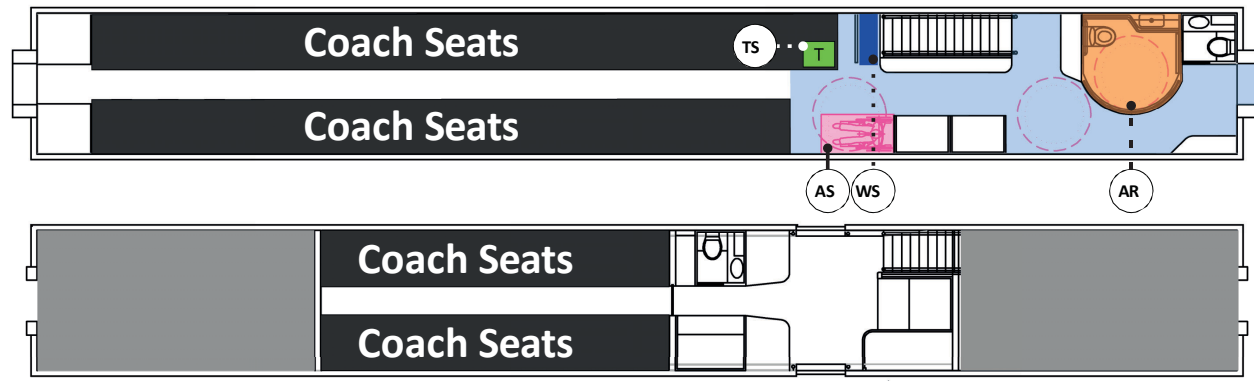

02 | Accessible Coach Car

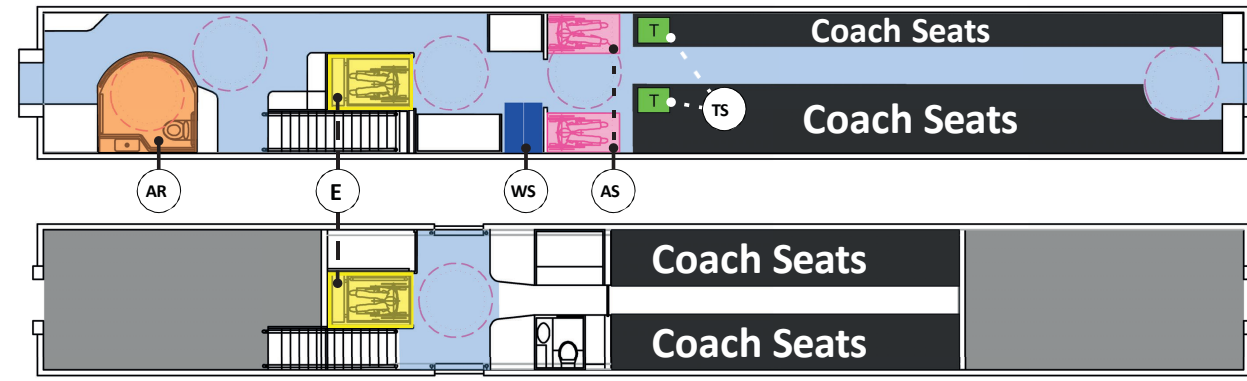

03 | Accessible Coach Cafe Car

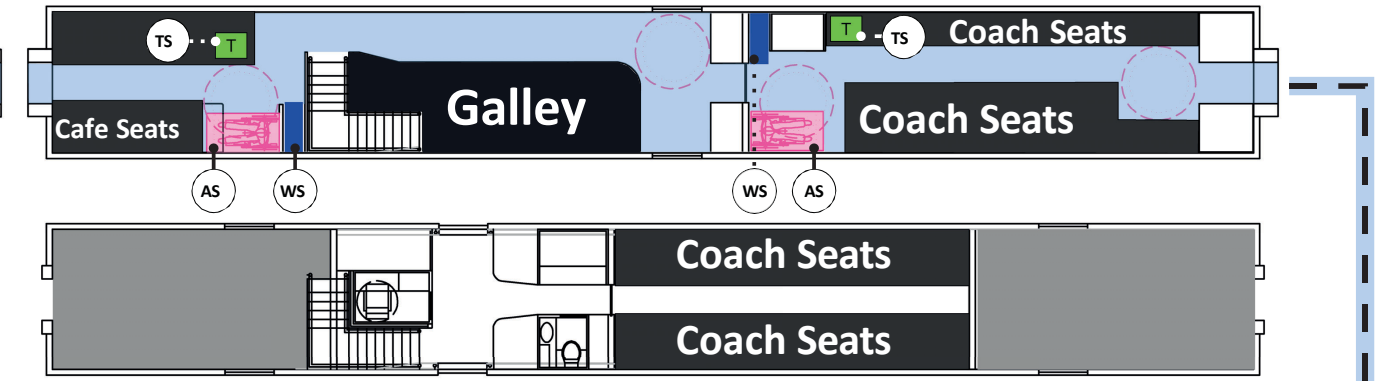

04 | Accessible Diner

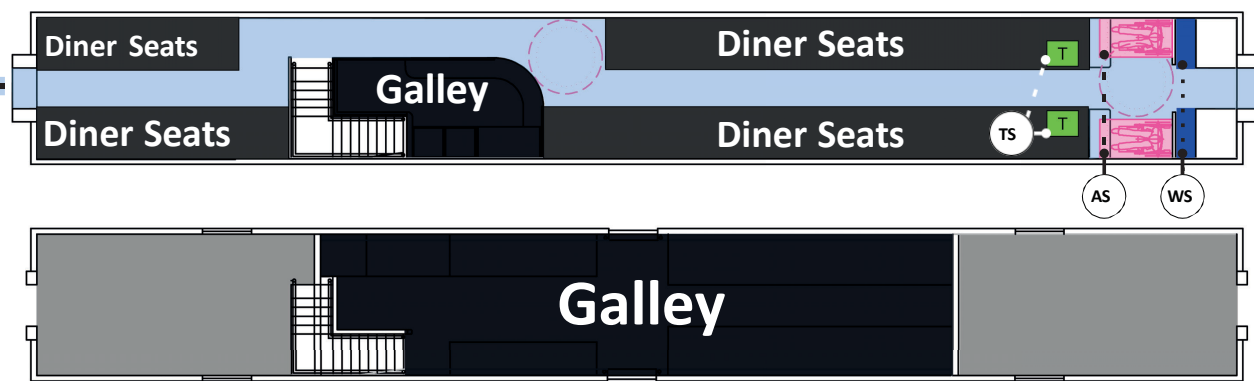

05 | Accessible Lounge

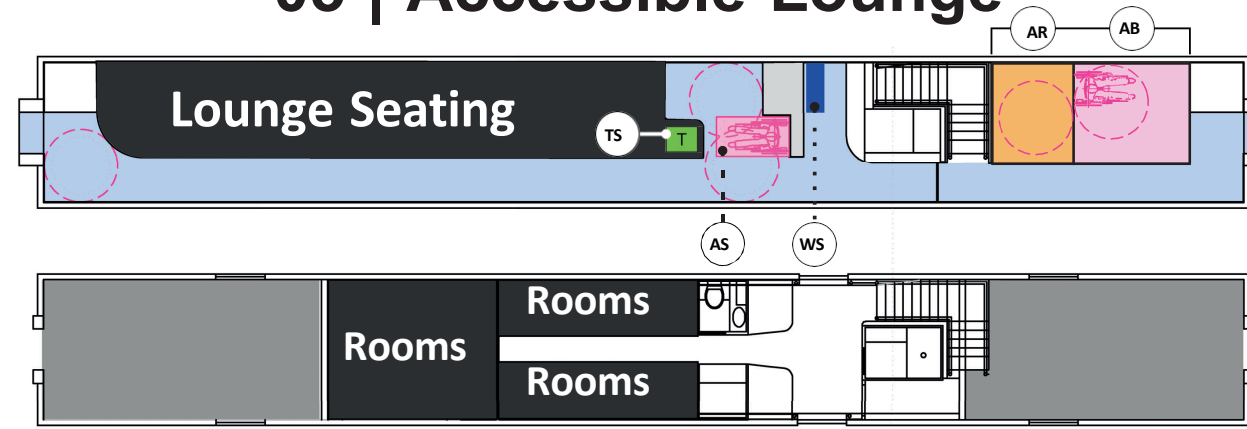

06 | Accessible Sleeper

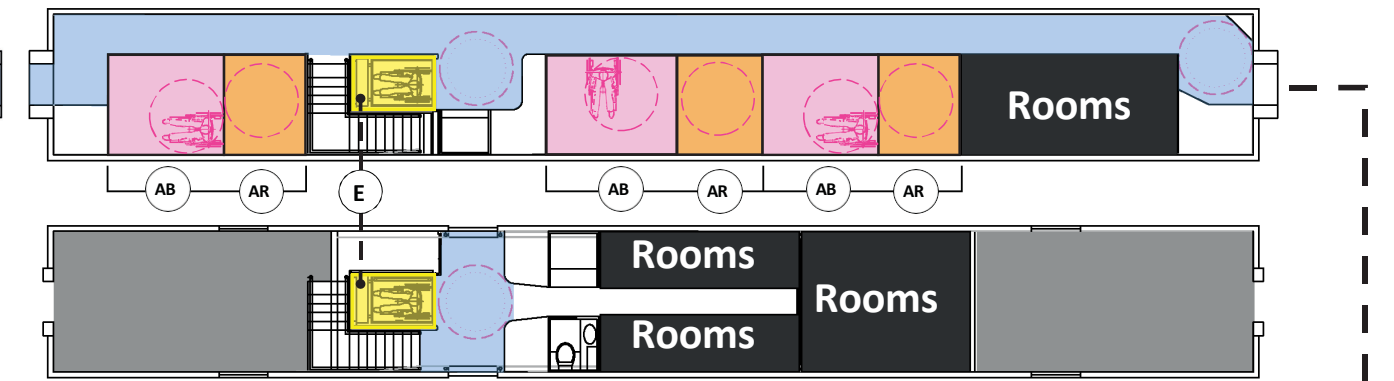

07 | Bedroom Sleeper

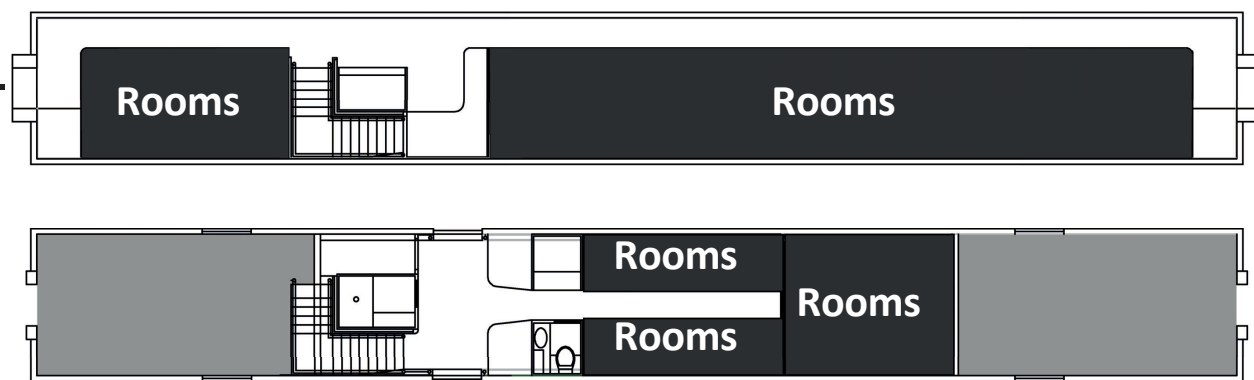

08 | Bedroom Sleeper

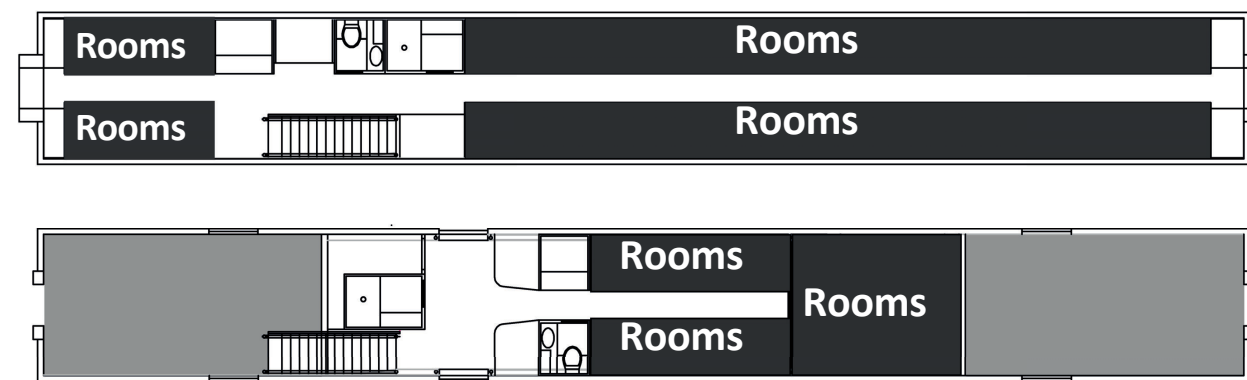

09 | Utility Car

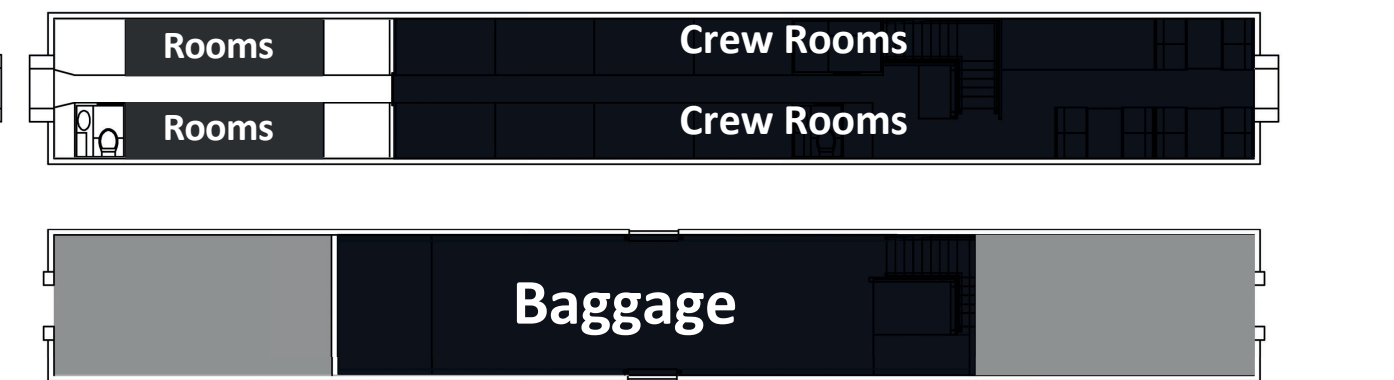

- AS Accessible Space
- E Elevator
- TS Transfer Seat
- AB Accessible Bedroom
- 32 32" Accessible Path
- WS Wheeled Mobility Device Storage Space
- AR Accessible Restroom
- 60 60" Turning Space
- AS Non-Accessible Seating, Rooms, or Crew Areas

Thank You!



August 30th, 2023