

“We’ve done Europe,  
Asia, even Africa.

THIS YEAR,  
AMERICA.”



## DISCOVER MORE OF AMERICA ABOARD AMTRAK

The best way to truly see America is from the broad windows of an Amtrak passenger rail car. Recline in your private accommodation or admire an all-encompassing view from the dome car. You will enjoy scenes of America not accessible by any other means of transportation. Travel in comfort and experience the kind of journey only a train can offer.

Take in American life in busy and remote regions of the USA. See children waving from front porches, moose drinking from pristine mountain streams, surfers along the Pacific Coast, cattle grazing under an open sky, picnics and baseball in the mid-west, black bears near Glacier National Park. Church steeples and flags greet you on the Atlantic shore between Philadelphia and Boston. In the West, California's Napa Valley and orchards beckon photographers and invite you to stop for a visit.

Amtrak trains take you directly to the center of America's best loved cities, including Los Angeles, Miami, and New York. Stay in the city or sleep in comfortable onboard accommodations as you cross the nation east to west through Glacier National Park or north to south along the winding Pacific and Atlantic Coasts. When you arise, enjoy continental or American breakfast on the train. Make friends over a glass of wine and dine on regional specialties like catfish and Mississippi Mud cake.

That is what awaits you as you journey aboard the train following the Mississippi River and "Blues Trail" through musical Memphis, St. Louis and New Orleans. Traveling east, The Deep South's bayous, bays, white-columned houses and cotton fields give way to Florida's everglades, sandy beaches, and man made attractions. Modern-day Texas cowboys, purple sunsets, blooming deserts and more are all on display from your vantage point aboard the train. In the hills, plains, woods and lake country of the Midwest, you can almost imagine America's First Nation's peoples and buffalo roaming free. Much of the country still remains untouched.

Authentic America – its cities, its forests, and its people – is waiting for you. Discover it aboard Amtrak.

## AMERICA'S BEST-LOVED TRAINS

### EMPIRE BUILDER®



Chicago - Milwaukee - St. Paul/Minneapolis - Glacier Park - Seattle - Portland

Travel the northern border of the USA near Canada for one of the greatest outdoors adventures in America. Cross sprawling farmlands as you journey over the Wisconsin River up steep hills and through one of the longest tunnels in North America. Follow the Mississippi River through river towns and rural fields as you travel to St. Paul/Minneapolis, "Twin Cities" on the banks of the Mississippi River, exactly midway between the Equator and North Pole! Ahead lie the Rocky Mountains and Glacier National Park where you will cross the Continental Divide and travel further west to Spokane and Seattle, Washington.

### CITY OF NEW ORLEANS®



Chicago - Memphis - Jackson, Mississippi - New Orleans

From Chicago to Memphis and along the "Blues Trail," birthplace of the musical genre, you'll discover the land and people of the South and treasured Mississippi Delta city of New Orleans. Onboard the train, enjoy the new Cross Country Cafe featuring specialties reminiscent of the culture of this uniquely-American region.

### COAST STARLIGHT®



Seattle - Portland - Sacramento - Los Angeles

The Coast Starlight travels from the port city of Seattle through varied terrain and along the shores of the Pacific Ocean. San Francisco and Los Angeles are favorite stops in California, but there's always something to discover. The city of Santa Barbara began an "AutoFree" zone to lessen greenhouse gases. Amtrak is pleased to be one of the most environmentally friendly means of transportation, with fewer emissions than auto and airplane travel.

### CITY TO CITY



Unlike air travel, Amtrak trains take you from city center to city center, saving you the problem and expense of arranging additional transportation once you arrive. Comfortable seating, full amenities, and friendly service are yours aboard Amtrak as you travel from New York to Washington, D.C., Los Angeles to San Diego, or Chicago to Minneapolis. Arrive relaxed and refreshed. Enjoy meeting other passengers and seeing the layout of the country and its landscapes.

## AMERICA'S BEST-LOVED TRAINS

### THE HIAWATHA®



Chicago - Glenview, Illinois - Sturtevant, Wisconsin - Milwaukee

This route is named for the beautiful Indian princess "Hiawatha," known well to American school children. Travel the beautiful shore of the Great Lake Michigan from Milwaukee to Chicago or vice versa. In Chicago, connect with over 500 destination served by Amtrak.

### NORTHEAST CORRIDOR



Boston - New York - Philadelphia - Washington - Richmond - Newport News

Travel to or from downtown New York, Boston, Philadelphia and Washington, D.C. Here you'll find American history and heritage, the arts, nightlife, cuisine, sports, and more. There are many places to enjoy along the way too — from beach stays in The Capitol Region USA to camping in upstate New York.

### SAN JOAQUINS®



San Francisco - San Joaquin Valley - Fresno - Bakersfield - Southern California

The San Joaquins runs multiple times daily between the San Francisco Bay Area or Sacramento and Bakersfield, where motorcoaches called "Thruway coaches" connect you to Southern California. You'll also travel through California's central valley, bordered by mountains and parks like Yosemite National Park. Sunshine, fruit trees, and flowers greet you as you gaze from your passenger car window.

### REGION TO REGION



America is vast and her regions are varied. Aboard Amtrak, tour the desert regions and mountains of the Southwest or Great Lakes Country near the Canadian border. Stunning views and memorable experiences are in store for you. Depending on your destination, Amtrak has two kinds of train services. Single-level train service operates on most short-distance routes. This service also operates on some long-distance trains along the East Coast of the USA. Many long-distance trains feature our Superliner Service. Superliner cars are bi-level cars with stairs connecting lower and upper levels. No matter where you go, or how you travel with Amtrak, you are guaranteed to enjoy the journey.

## GETTING THERE SHOULD BE JUST AS EXCITING AS BEING THERE

Your journey matters as much as the experience that awaits you at your destination. That's the main reason travelers prefer Amtrak. With 9.6 million square kilometers, the United States of America features many incredible destinations within the destination. Amtrak transports you in comfort from city to city or across the span of the country. It is simply the best way to visit America. Our long-distance trains offer you dining as well as comfortable accommodations. Meals are included in the price of Sleeping Car tickets, so there are no decisions to make about where to dine or find a hotel! Passengers without Sleeping Car tickets, i.e. passengers traveling in "coach class," may also dine; for an additional charge.



# THE AMTRAK SYSTEM

SERVING OVER 500 DESTINATIONS ACROSS AMERICA



VISIT [AMTRAK.COM](http://AMTRAK.COM)  
OR CALL YOUR  
TRAVEL AGENT FOR MORE  
INFORMATION.

Ask about an Amtrak Rail Pass to  
travel the US at a low price.

# Dining Cars



Great food, amazing views—Amtrak Dining Cars offer a truly unique experience. Large windows on both sides of the car offer panoramic views of the passing scenery while you enjoy a family-style dining experience on rails. Choose from a variety of offerings, including vegetarian dishes and children’s meals. Vegan and kosher meals may be ordered 72 hours in advance. And, all meals are included with purchase of a Sleeping Car accommodation ticket.

## single-level dining car

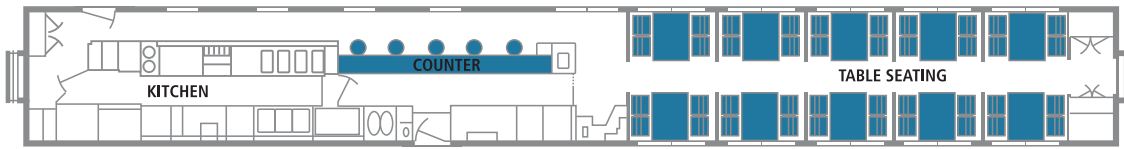

## superliner® dining car

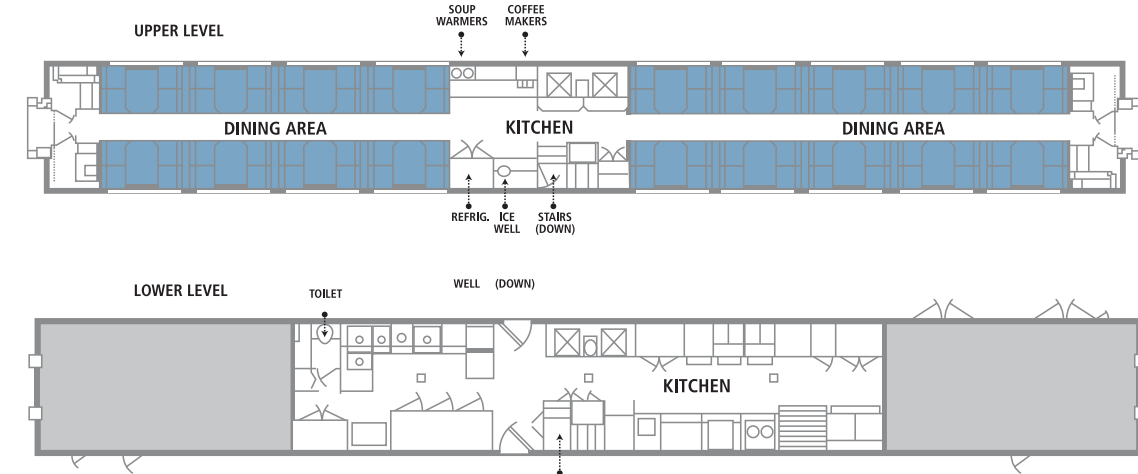

# Sleeping Cars



You'll want to be well rested—fortunately, we can help. Our Sleeping Car accommodations provide long-distance travelers the choice of a Roomette, Bedroom or Bedroom Suite (two adjoining bedrooms) that can accommodate one to four people. Daytime seating converts to beds at night. Electrical outlets, climate controls, reading lights, a small closet and fold-down table are all within easy reach. In Superliner® Roomette service, restrooms and a shower are located nearby. Viewliner® Roomettes feature in-room toilet and washbasin facilities. Bedrooms offer a sink and vanity with enclosed toilet and shower facilities. Accessible bedrooms are available with in-room sink and toilet. Bed linens and soap are always included, as are Dining Car meals, bottled water, morning coffee and juice, the daily newspaper and the assistance of a Sleeping Car attendant.

## viewliner® sleeper

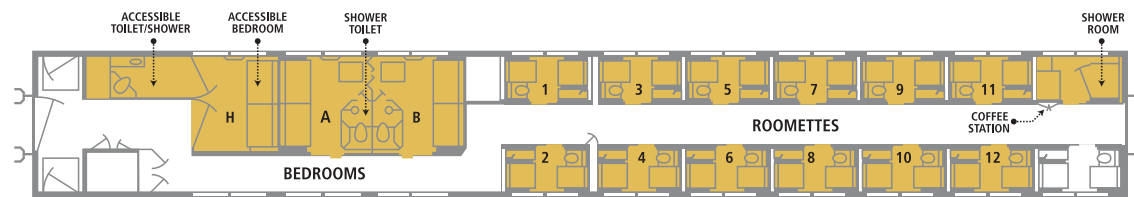

### VIEWLINER® BEDROOM

**Dimensions:**  
6'8 x 7'1 (2m x 2.2m)  
**Lower berth:**  
3'4 x 6'0 (1m x 1.8m)  
**Upper berth with steps:**  
2'4 x 6'2 (72 cm x 1.9m)

Accommodates 2 adults.  
Capacity for 2 small suitcases.  
In-room sink and vanity with enclosed toilet and shower.

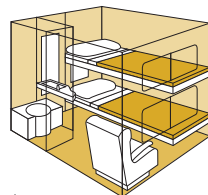

### VIEWLINER® ACCESSIBLE BEDROOM

**Dimensions:**  
6'8 x 7'1 (2m x 2.2m)  
**Lower berth:**  
3'4 x 6'0 (1m x 1.8m)  
**Upper berth with steps:**  
2'4 x 6'2 (72 cm x 1.9m)

Accommodates 2 adults.  
Capacity for 2 small suitcases and garment bag.  
Enclosed toilet, shower, sink and vanity.

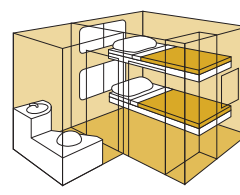

### VIEWLINER® ROOMETTE

**Dimensions:**  
3'6 x 6'8 (1.1m x 2m)  
**Lower berth:**  
2'4x6'6 (72 cm x 2m)  
**Upper berth with steps:**  
2'4 x 6'2 (72 cm x 1.9m)

Accommodates 2 adults.  
Capacity for 2 small suitcases and garment bag.  
In-room toilet and washbasin.

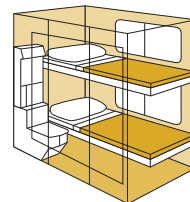

## superliner® sleeper

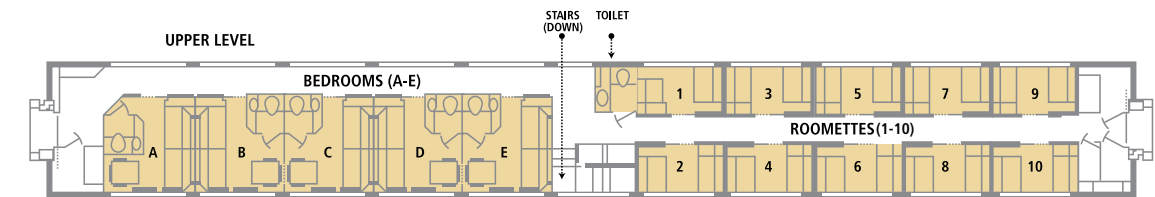

### SUPERLINER® BEDROOM

**Dimensions:**  
6'6 x 7'6 (2m x 2.3m)  
**Lower berth:**  
3'4 x 6'3 (1m x 1.9m)  
**Upper berth with steps:**  
2'4 x 6'2 (72 cm x 1.9m)

Accommodates 2 adults.  
Capacity for 2 suitcases.  
Some bedrooms can be combined to make a suite for 4 people.  
In-room sink and vanity with enclosed toilet and shower.

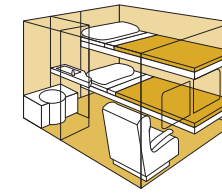

### SUPERLINER® ROOMETTE

**Dimensions:**  
3'6 x 6'8 (1.1m x 2m)  
**Lower berth:**  
2'4x6'6 (72 cm x 2m)  
**Upper berth with steps:**  
2'4 x 6'2 (72 cm x 1.9m)

Accommodates 2 adults.  
Capacity for 2 small suitcases.

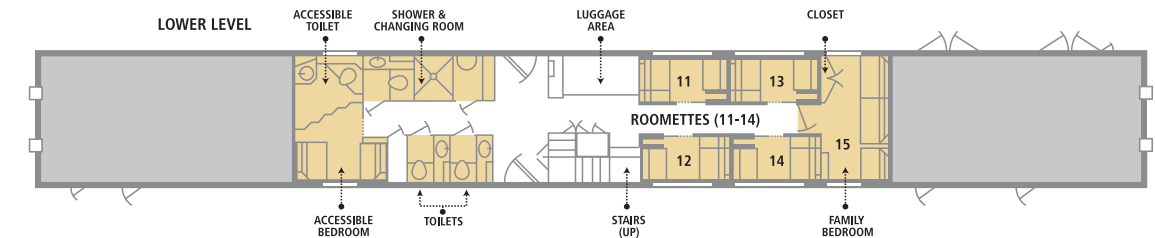
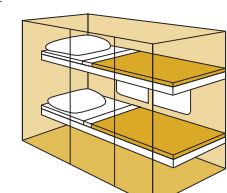

### SUPERLINER® ACCESSIBLE BEDROOM

**Dimensions:**  
6'9 x 9'5 (2m x 2.9m)  
**Lower berth:**  
2'4 x 6'6 (72cm x 2m)  
**Upper berth with steps:**  
2'0 x 6'2 (61cm x 1.9m)

Accommodates 2 adults.  
Capacity for 2 small suitcases  
In-room toilet and sink are separated from the room by a curtain. Ample space for wheelchair.

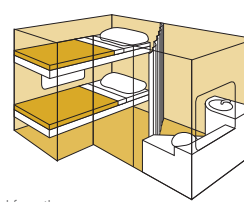

### SUPERLINER® FAMILY BEDROOM

**Dimensions:**  
5'2 x 9'5 (1.6m x 2.9m)  
**Lower berth with ladder:**  
Upper berth: 2'4 x 6'2 (72cm x 1.9m)  
Lower berth: 3'4 x 6'3 (1m x 1.9m)  
**2 Child berths:**  
Upper berth: 2'0 x 4'7 (61cm x 1.4m)  
Lower berth: 2'3 x 4'9 (69cm x 1.5m)

Accommodates 2 adults and 2 small children.  
Capacity for 2-3 suitcases. Restrooms and a shower are nearby.

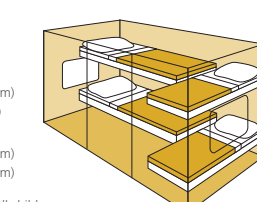

# Coach Cars

Comfortable and economical, Coach Class offers large, reclining seats with fold-down tray tables, overhead reading lights and overhead luggage racks. Plus, with large, panoramic windows, you can lean back and enjoy the view. If you want to get up and stretch your legs, there's plenty of room to walk around, with restrooms conveniently located in every car.

## single-level coach

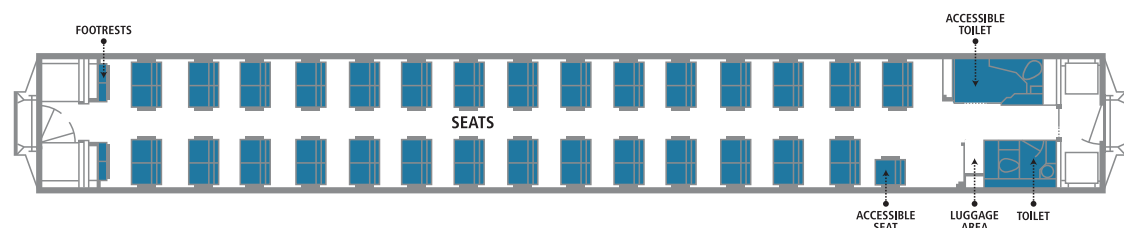

## superliner® coach

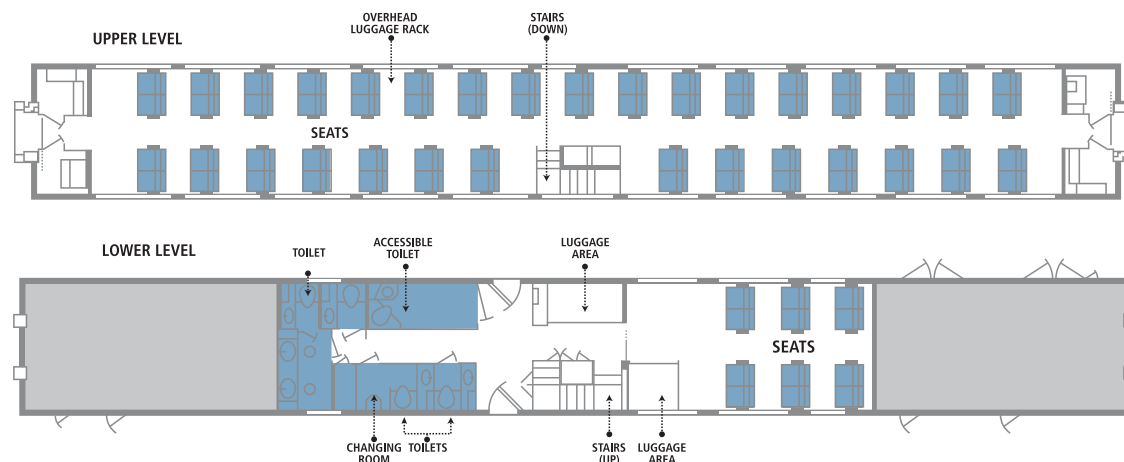

# Café/Lounge Cars

Available in most Amtrak® long-distance trains, the Lounge Car is a popular place to grab a quick snack, unwind or meet new people. The upper level of our Sightseer Lounge Cars offers a more dramatic view of the passing scenery with wraparound windows. Or, if you prefer, you're always welcome to enjoy your sandwiches, soft drinks, beer and wine or cocktails in the car or back at your seat.

## single-level cafe/lounge car

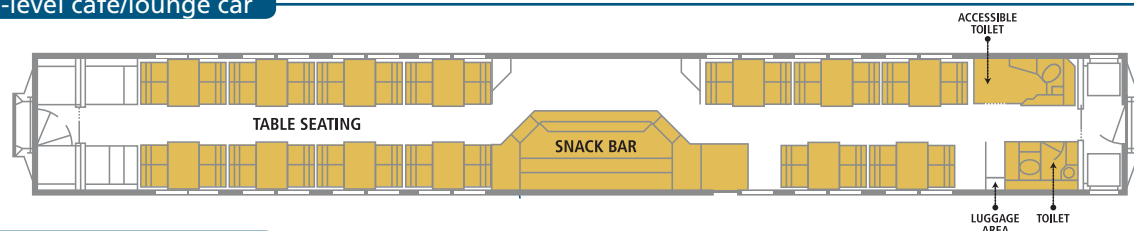

## sightseer lounge car

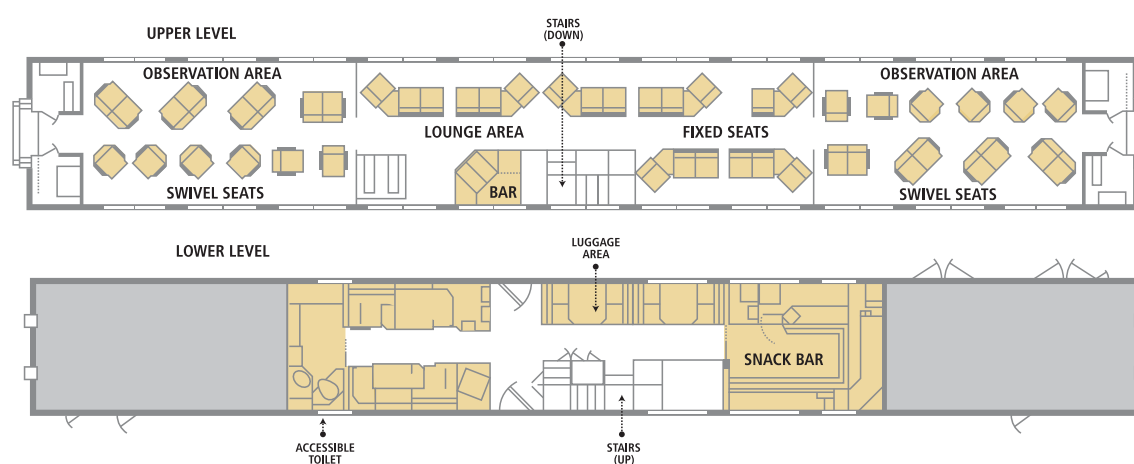

NOTE: While you reserve sleeping accommodations, coach seating is on a first-come basis on most Amtrak trains. However, once on board, your conductor may assign seats. To reach Amtrak while in America, call 1-800-USA-RAIL.

IT'S THE JOURNEY, AND  
THE DESTINATION.  
AMERICA ABOARD AMTRAK.

For current schedules, fares and additional information,  
call your Travel Agent or visit Amtrak.com.

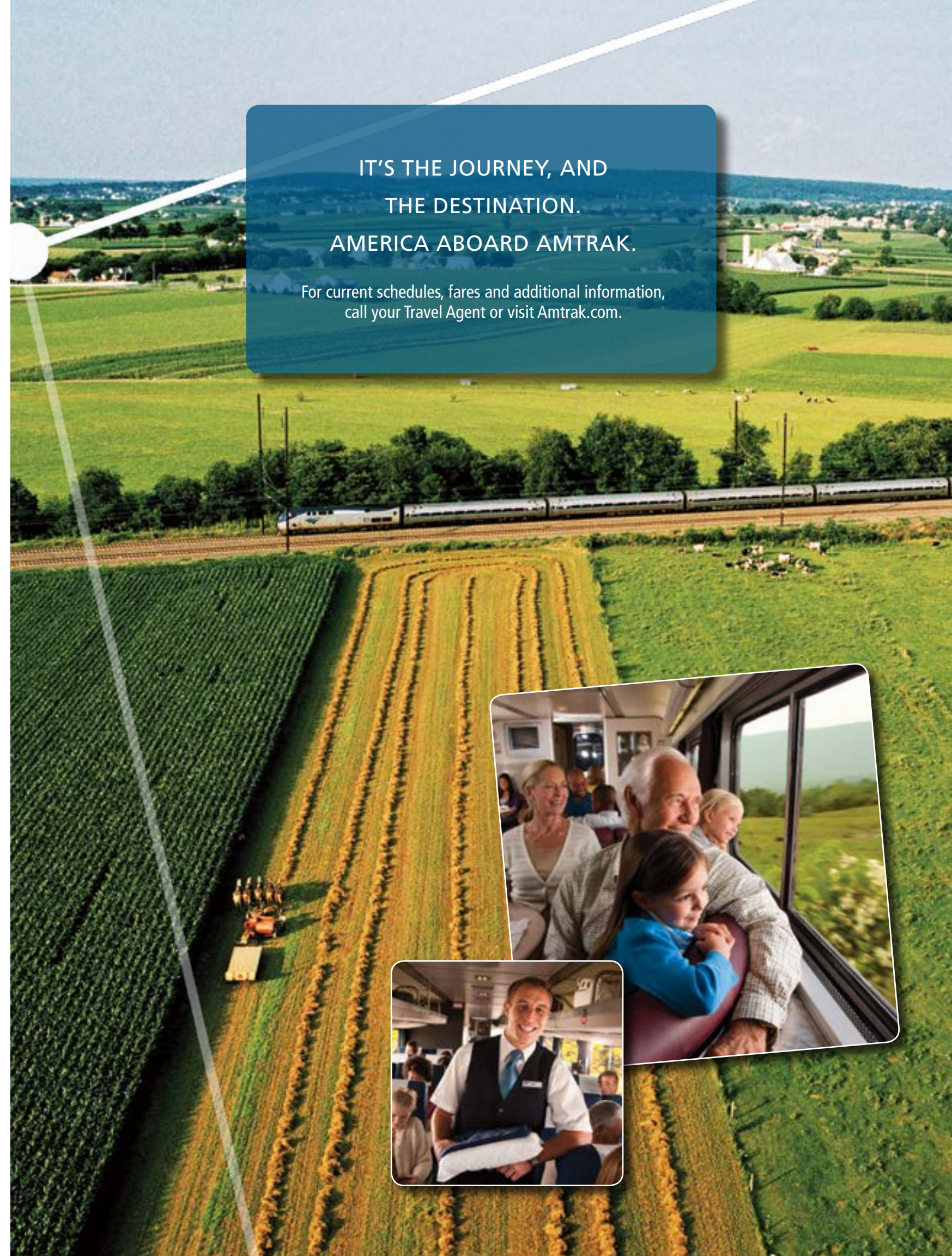

## 2016-2017 RAIL VACATIONS

Top Destinations in the  
U.S. and Canada

ORDER YOUR  
FREE 2016  
Brochure Today at  
[AmtrakVacations.com](http://AmtrakVacations.com)

AVAILABLE IN PRINT  
OR VIEW ONLINE



AMTRAK  
Vacations



# Amtrak® Vacations

*offers over 300 rail vacations  
to amazing cities and spectacular  
National Parks*

## Jazz Blues and Rock 'n' Roll

9 DAYS / 8 NIGHTS

### VACATION HIGHLIGHTS:

- Chicago multi-day hop-on, hop-off sightseeing tour
- Guided tour of Memphis with admission to Graceland
- Battlefield Cruise in New Orleans on a paddlewheel boat
- Guided City Tour of New Orleans

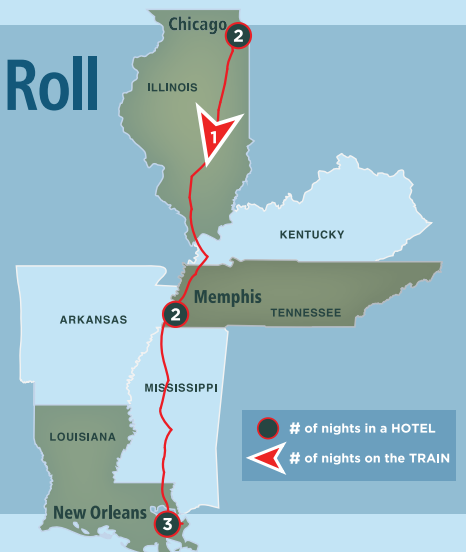

## Yellowstone to Yosemite

11 DAYS / 10 NIGHTS

### VACATION HIGHLIGHTS:

- Chicago hop-on, hop-off sightseeing tour
- Lower Loop Tour of Yellowstone National Park
- Narrated tour of Salt Lake City
- Guided Yosemite National Park Day Tour



AMTRAK®  
**Vacations**

For full package details, visit our website at [AmtrakVacations.com](http://AmtrakVacations.com) or call **800-268-7252**

\*Call for pricing. Other restrictions may apply. Amtrak and Amtrak Vacations are registered service marks of the National Railroad Passenger Corporation.